

STATE OF UTAH STATE ROAD COMMISSION

PLANS OF PROPOSED STATE ROAD FEDERAL AID PROJECT WEBER COUNTY Sec. A Ogden - North Ogden - Length 2.660 Miles

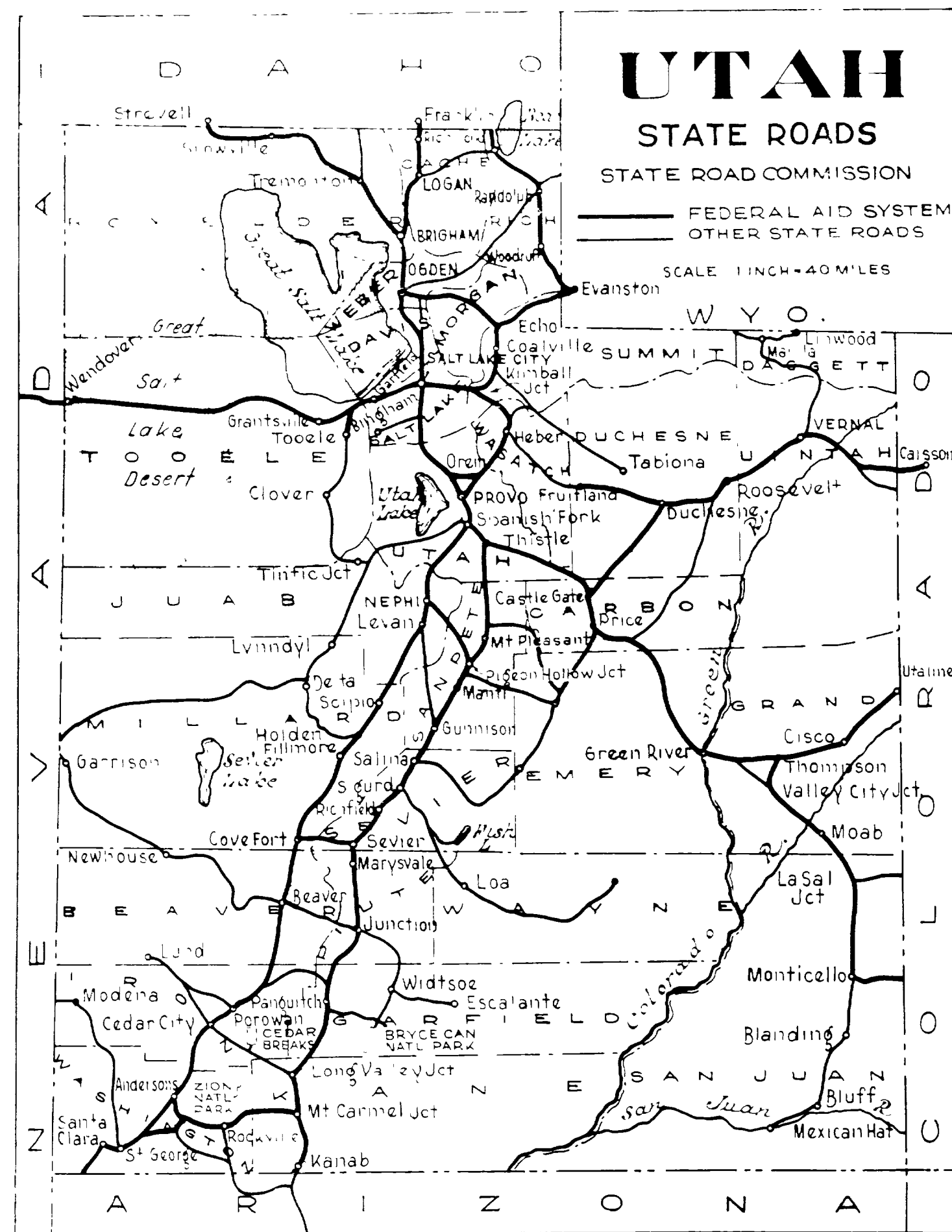

Scales { Plan 1" = 100'
Profile { Horizontal 1" = 100'
 Vertical 1" = 10'

INDEX TO SHEETS F. A. P. No. 125-A

SHEET No.	DESCRIPTION	DRAWING No.	DATE
1	Title Sheet		
2	Typical Section	Type "Spl"	
3-7	Plan and Profile		
8	7x2'6" Conc. Box (Extend 16 ft)	E-397	10-15-56
9	2x2 x 56'-8" Conc. Box	E-163-L19	Various
10	3x2 x 53'-6" Conc. Box	E-164-L17	11-2-56
11A	FAP and R/W Markers	J-391-R	
11-B	Gross Section		

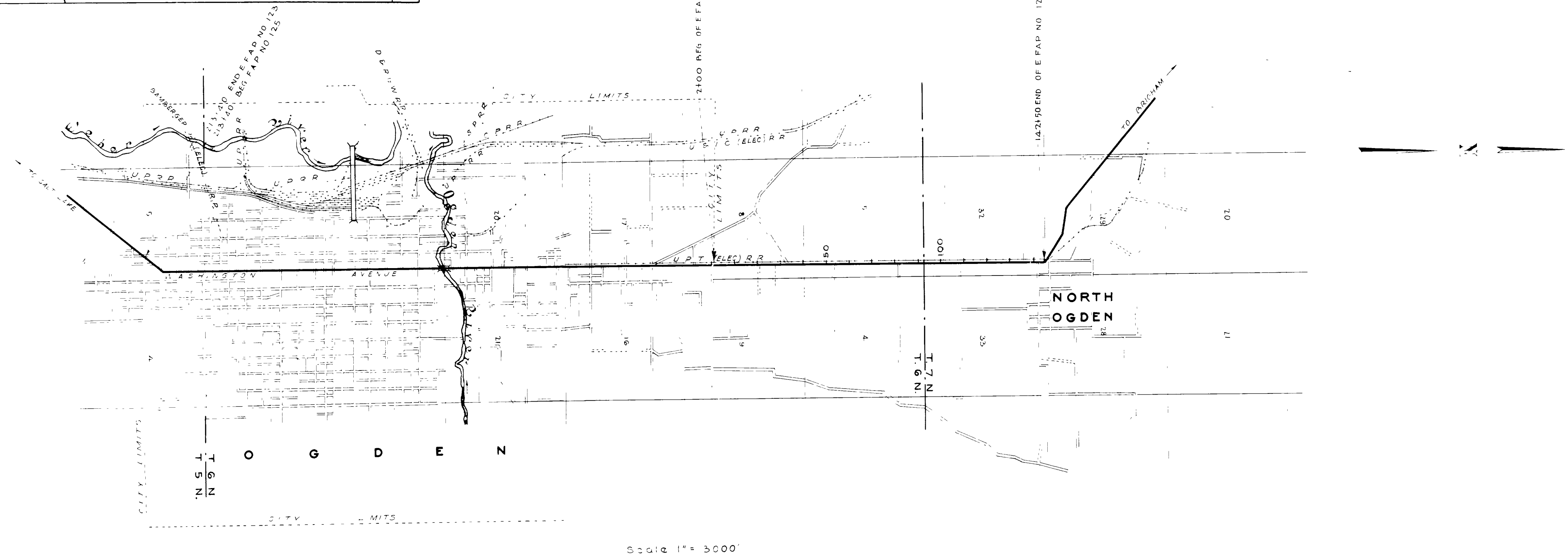

APPROVED 5 20 52 1952
STATE ROAD COMMISSION OF UTAH

Henry H. Wood
CHAIRMAN

Proctor Peterson
MEMBER

W. J. Parker
MEMBER

[Signature]
CHIEF ENGINEER

FOR APPROVAL

ENGINEER'S BUREAU OF PUBLIC PLANS

O G D E N

7100
BEGINNING OF FED AID PROJECT
NO 125-A

PLAN	SURVEYED	BY	DATE
NOTE BOOK	ALIGNED CHECKED	G. L. RAMS	12.31
NO.	RT. OF WAY CHECKED	H. W. LIGHT	"
	PLACED	H. W. LIGHT	12.31

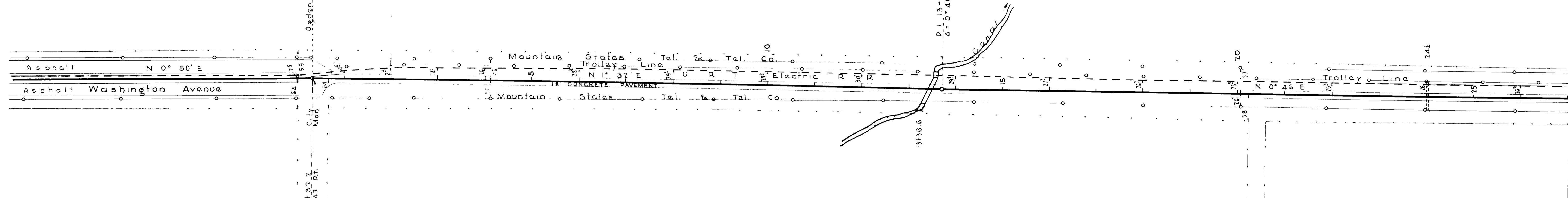

LIST OF STRUCTURES

STATION	IN PLACE	REQUIRED	REMARKS	DRAWING
13+36.6 24±	7' x 2'-6" Conc Box	Extend 16' RT 24' x 60' Conc Pipe		E 897

PROFILE	SURVEYED	BY	DATE
NOTE BOOK	PLOTTED	G. L. RAMS	12.31
NO. 6.5	8 WS NOTED	H. W. LIGHT	"
	STRUCTURE NOTATIONS CH'KD.	H. W. LIGHT	12.31

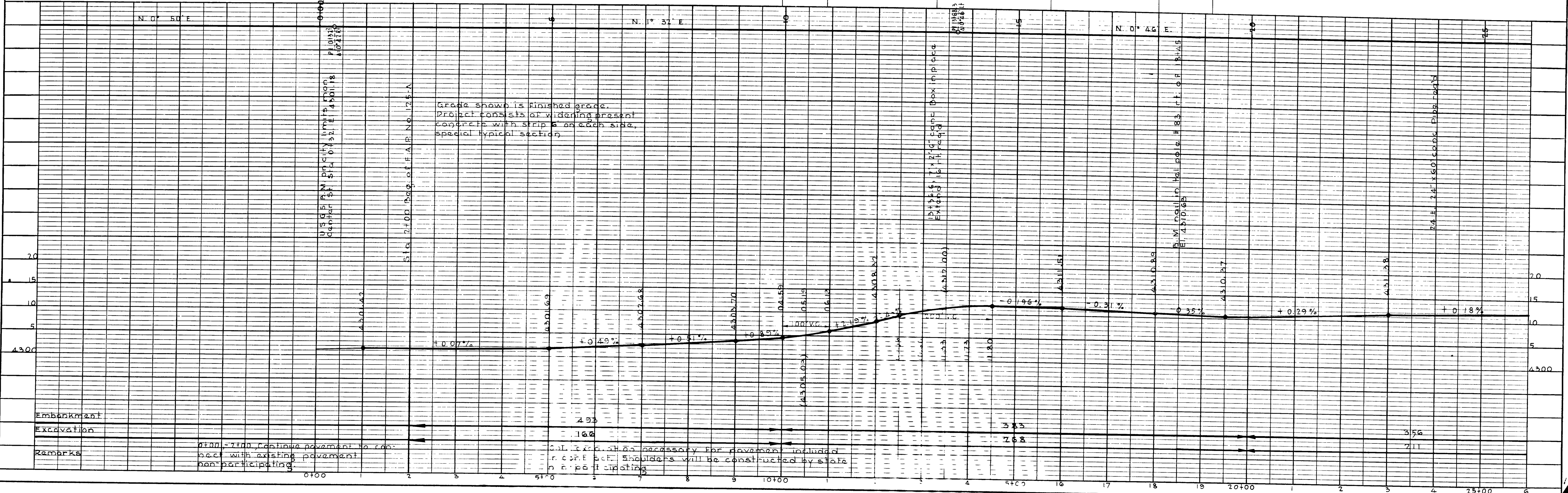
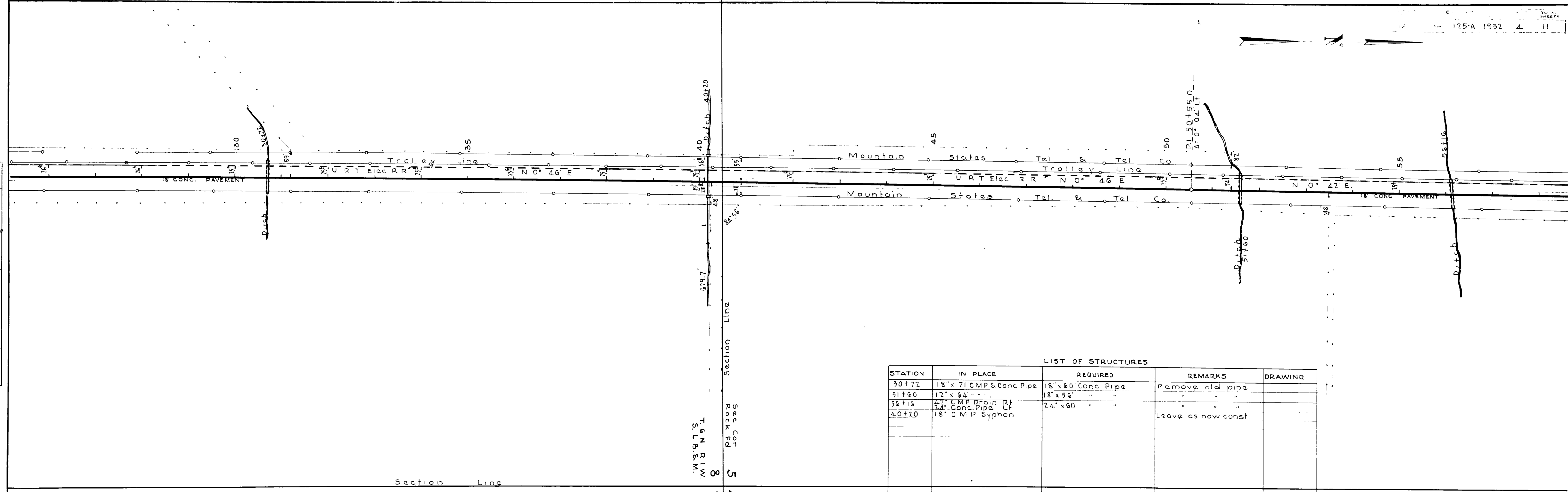

PLATE 1-PLAN-PROFILE OF P & R E STANDARD
KUEPPEL & ESSER CO., NEW YORK

PLAN	DATE	BY
NO. 64	1932	C. L. G. W. S.
NOTE BOOK	ALIGNED CHECKED	H. S. W. F. D. T.
NO. 64	1932	H. S. W. F. D. T.

PROFILE	DATE	BY
NO. 65	1932	C. L. G. W. S.
NOTE BOOK	GRADES CHECKED	H. S. W. F. D. T.
NO. 65	1932	H. S. W. F. D. T.



STATION	IN PLACE	REQUIRED	REMARKS	DRAWING
30+72	18" x 7' C.M.P. & Conc. Pipe	18" x 60' Conc. Pipe	Remove old pipe	
51+60	12" x 6' "	18" x 56' "	"	
56+16	24" C.M.P. Drain Lt	24" x 60' "	"	
40+70	18" C.M.P. Syphon		Leave as now const	

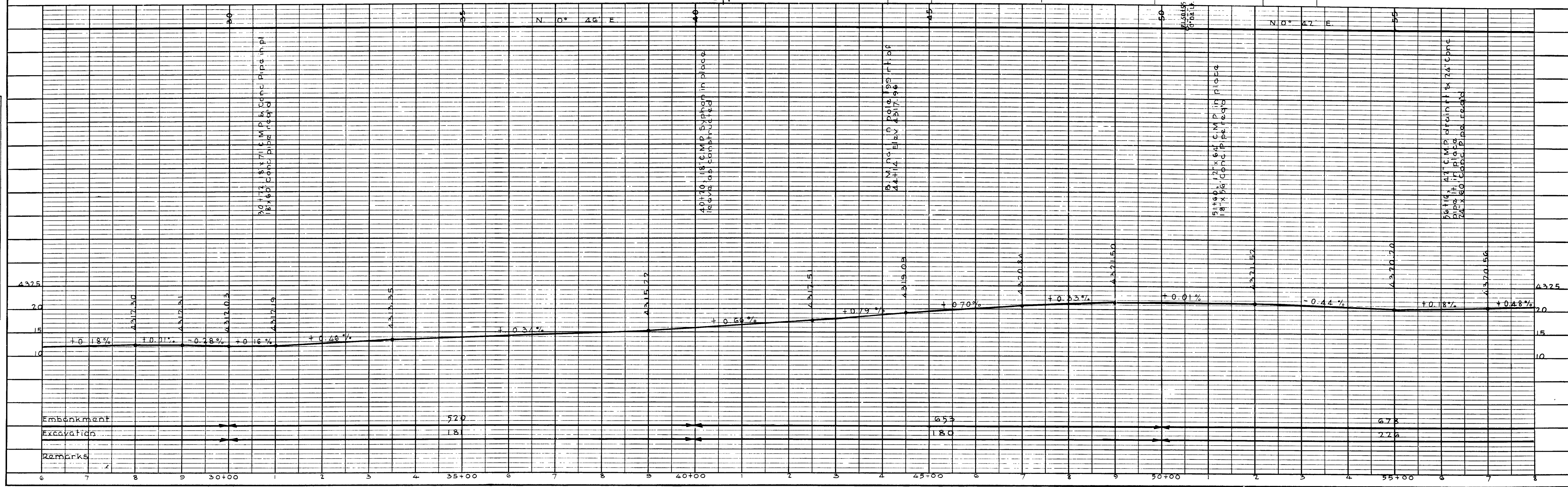

PLAN

SURVEYED	C. L. GAWALS	DATE	1932
PLOTTED	H. S. W.		
ALIGNMENT CHECKED	H. S. W.		
NOTE BOOK CHECKED	H. S. W.		
BY	H. S. W.		
DATE	1932		

PROFILE

SURVEYED	C. L. GAWALS	DATE	1932
GRADES CHECKED	H. S. W.		
BY	H. S. W.		
DATE	1932		
STRUCTURE NOTATIONS CHKD.			

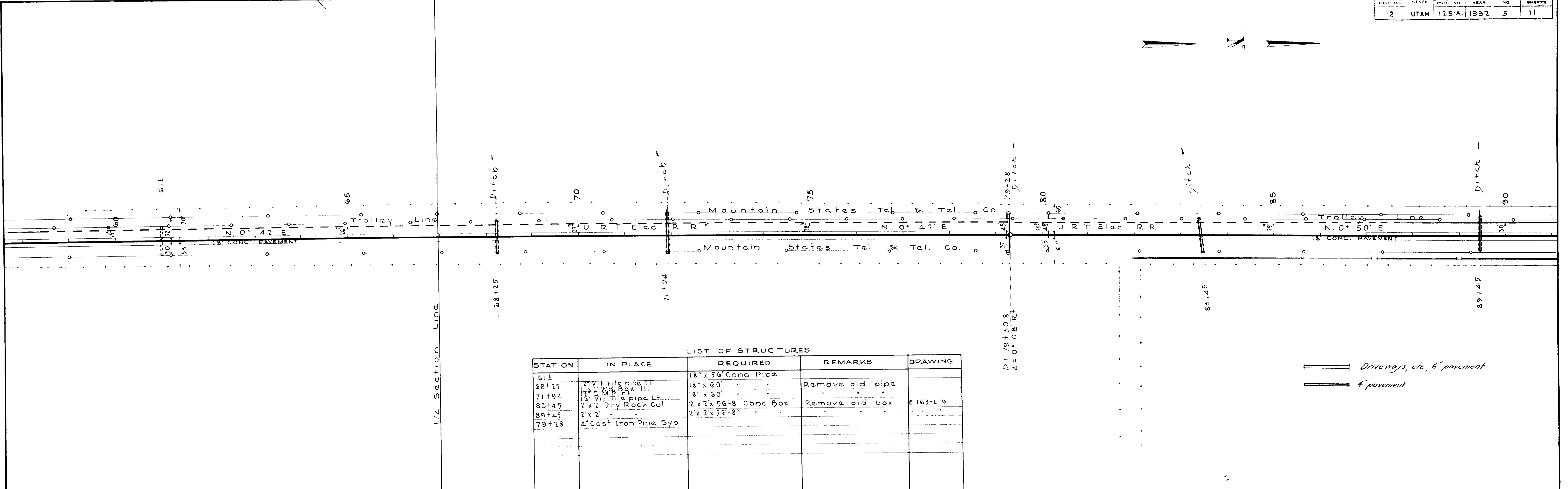

LIST OF STRUCTURES

STATION	IN PLACE	REQUIRED	REMARKS	DRAWING
61±		18" x 56" Conc Pipe		
68+25	12" Vit Tile pipe ft	18" x 60"	Remove old pipe	
71+94	12" Conc Box ft	18" x 60"		
83+45	2' x 2' Vit Tile pipe ft	2' x 2' x 56-8" Conc Box	Remove old box	E 163-L19
89+45	2' x 2' "	2' x 2' x 56-8"		
79+28	4" Cast Iron Pipe Syp			

Drive ways, etc, 6" pavement

4" pavement

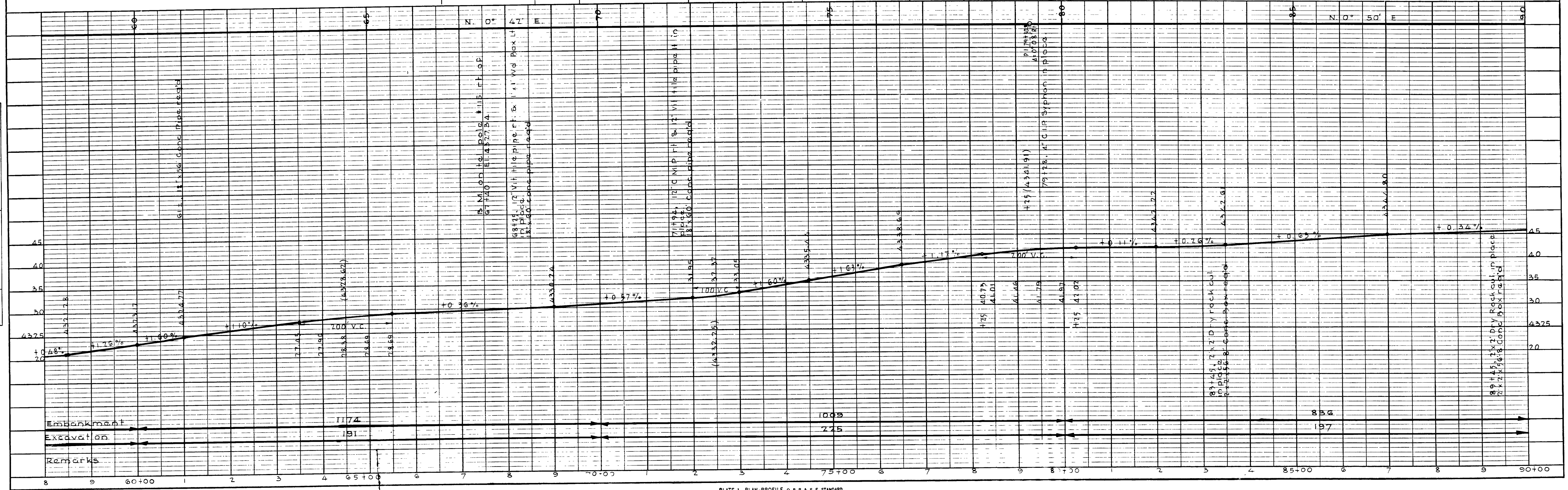
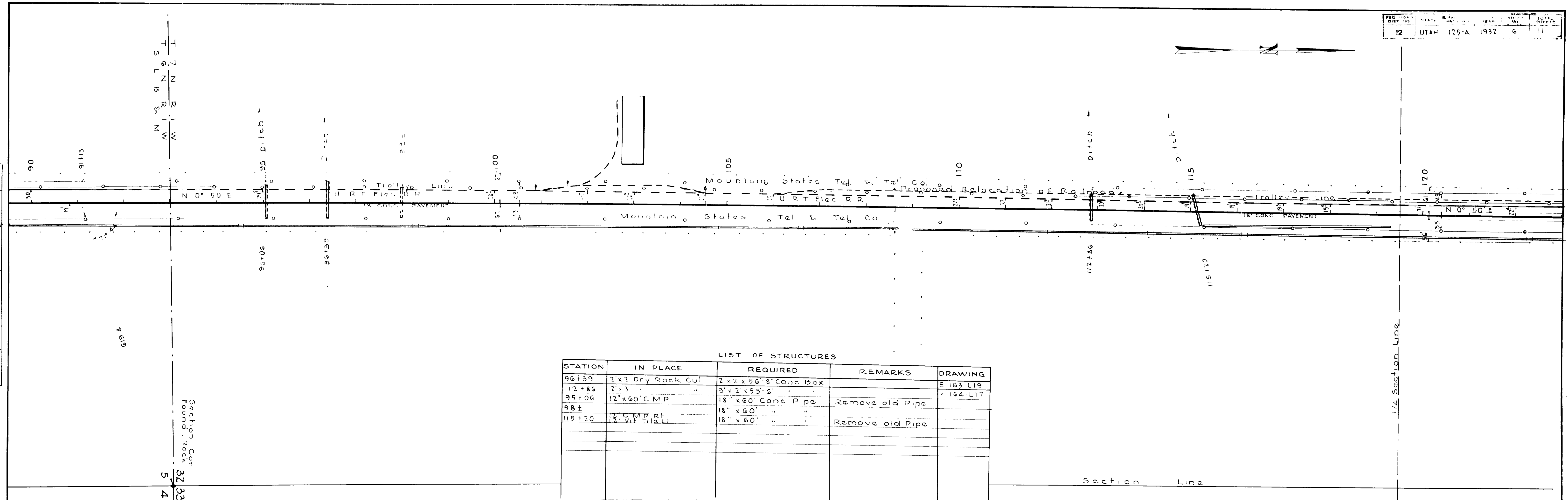

PLATE 1-PLAN-PROFILE OF ROAD STANDARD
KUPFFEL & ESSER CO. NEW YORK

PLAN
 SURVEYED BY C. L. WILSON
 DATE 12-22-32
 NOTE BOOK ALIGNED CHECKED H. S. WILSON
 RT. OF WAY CHECKED H. S. WILSON
 NO. 624
 PROJECT 1932

PROFILE
 SURVEYED BY C. L. WILSON
 DATE 12-22-32
 NOTE BOOK GRADES CHECKED H. S. WILSON
 B. M. NOTED H. S. WILSON
 NO. 624
 STRUCTURE NOTATIONS CHG.



LIST OF STRUCTURES

STATION	IN PLACE	REQUIRED	REMARKS	DRAWING
96+39	2'x2 Dry Rock Cul	2'x2 x 56'-8" Conc Box		E 163 L19
112+86	2'x3 "	3'x2 x 53'-6" "		" 164-L17
95+06	12" x 60' C.M.P.	18" x 60' Conc. Pipe	Remove old Pipe	
98±	12" C.M.P. RT.	18" x 60' "		
115+20	12" V.I.T. LI	18" x 60' "	Remove old Pipe	

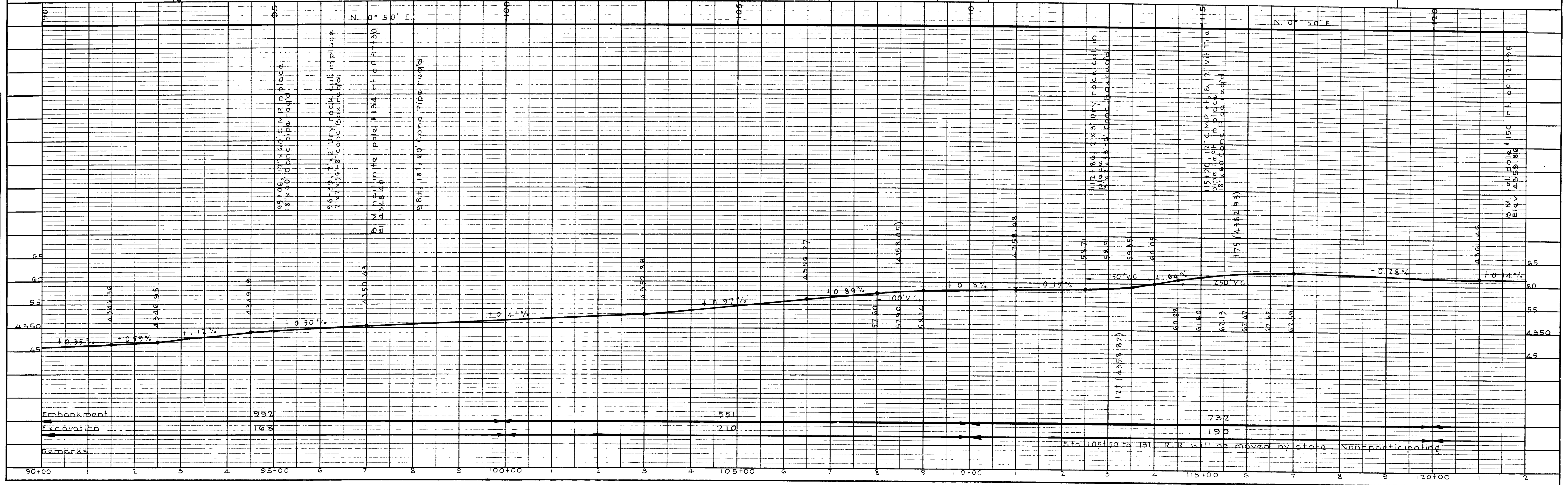

NORTH OGDEN

PLAN

SURVEYED	BY	DATE
NOTE BOOK ALIGNED CHECKED	C. L. CALWIS	1932
RT OF WAY CHECKED	H. S. WELCH	
NO. 125	H. S. WELCH	1932

PROFILE

SURVEYED	BY	DATE
NOTE BOOK CHECKED	C. L. CALWIS	1932
STRUCTURE NOTATIONS CHECKED	H. S. WELCH	
NO. 125	H. S. WELCH	1932

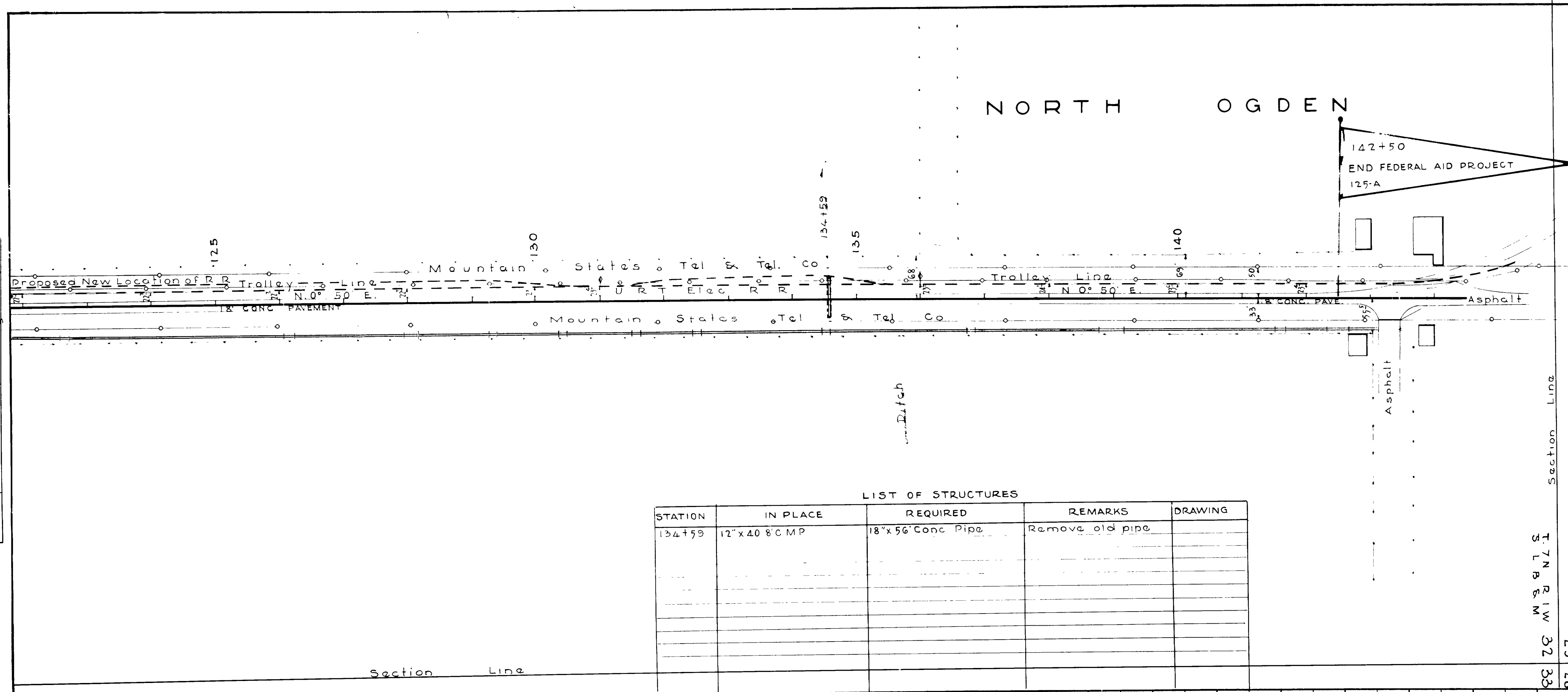

LIST OF STRUCTURES

STATION	IN PLACE	REQUIRED	REMARKS	DRAWING
134+59	12' x 40' 8' C.M.P.	18' x 56' Conc Pipe	Remove old pipe	

